

First Floor Plan 1:100

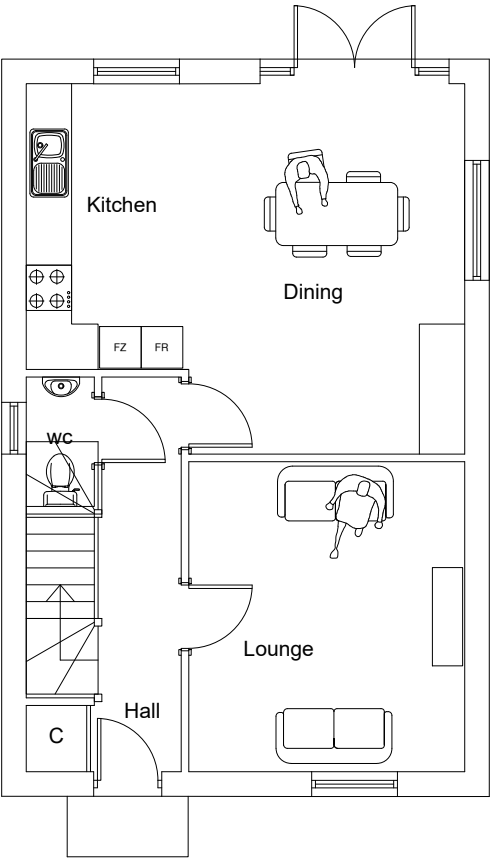

Ground Floor Plan 1:100

Detached 3 bedroom dwelling to rear of site- Unit 6

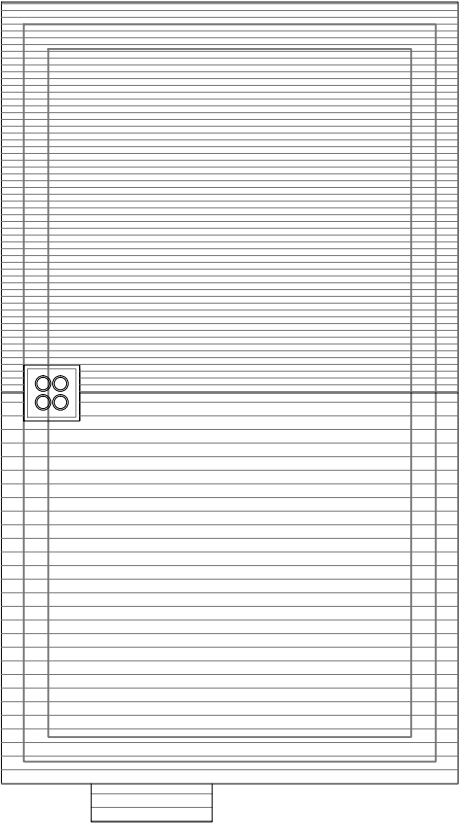

Roof Plan 1:100

- NOTES:**
1. The contents of this drawing are copyright.
 2. Scaled drawing for Planning purposes only.
 3. Contractors must verify all dimensions and report any discrepancies before putting work in hand or making any shop drawings.
 4. Lower ground construction/ retaining structure to be structural engineers design.
 5. Electrical layouts to be agreed with client & added to drawing
 6. Drawings to be read in conjunction with specification.

A	27.05.21	Window added to Dining Area, side elevation	NDP
Rev	Date	Description	By PM

REVISIONS:

PROJECT STAGE: PLANNING

CLIENT:
Mr Ayres & Mr & Mrs Bates

PROJECT & DRAWING TITLE:
80-84 Glenville Road, Walkford, Christchurch

Proposed Plans

Scale @ A3:1:100	Drawn by: CW	
Date: 10/11/20		
DRAWING No: ASP.20.040.102	REVISION: A	

ARCHITECTURE - PLANNING - PROJECT MANAGEMENT - CDM

4 Stour Road, Christchurch,
Dorset, BH23 1PS
01202 473222
www.aspirearchitects.co.uk
info@aspirearchitects.co.uk
© Aspire Architects Ltd



Aspire
Architects

